

*は標準品です。

| 寸法 | ϕD | $\phi D1$ | H | H1 | R |
|-------------|----------|-----------|-----|----|----|
| * 25x530x60 | 29.5 | 25.0 | 517 | 38 | 60 |
| 25x600x60 | 29.5 | 25.0 | 600 | 38 | 60 |
| 25x650x60 | 29.5 | 25.0 | 650 | 38 | 60 |
| 25x700x60 | 29.5 | 25.0 | 700 | 38 | 60 |
| 25x750x60 | 29.5 | 25.0 | 750 | 38 | 60 |
| * 32x450x76 | 37.5 | 31.75 | 455 | 43 | 76 |
| 32x500x76 | 37.5 | 31.75 | 500 | 43 | 76 |
| 32x550x76 | 37.5 | 31.75 | 550 | 43 | 76 |
| 32x600x76 | 37.5 | 31.75 | 600 | 43 | 76 |
| 32x650x76 | 37.5 | 31.75 | 650 | 43 | 76 |
| 32x700x76 | 37.5 | 31.75 | 700 | 43 | 76 |
| 32x750x76 | 37.5 | 31.75 | 750 | 43 | 76 |
| * 38x390x90 | 44.0 | 38.0 | 390 | 50 | 90 |
| 38x500x90 | 44.0 | 38.0 | 500 | 50 | 90 |

| | | | | |
|----------------|------|-----|--------|--------|
| 1 | 本体 | 黄銅管 | C2700T | |
| 番号 | 部品名 | 材質名 | 材質記号 | 備考 |
| 品名 | ステッキ | | | 尺度 |
| 品番 | M6S | | | 原図A3 |
| 大阪市北区天満1丁目6-7 | | | | フォルダ |
| ミヤコ株式会社 | | | | 1 |
| | | | | 図番 |
| | | | | M6S-12 |

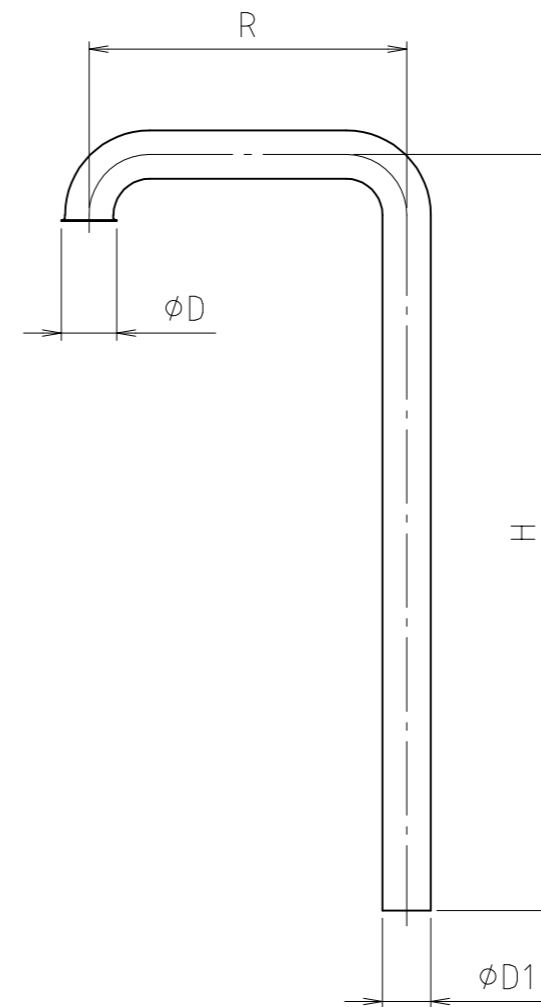
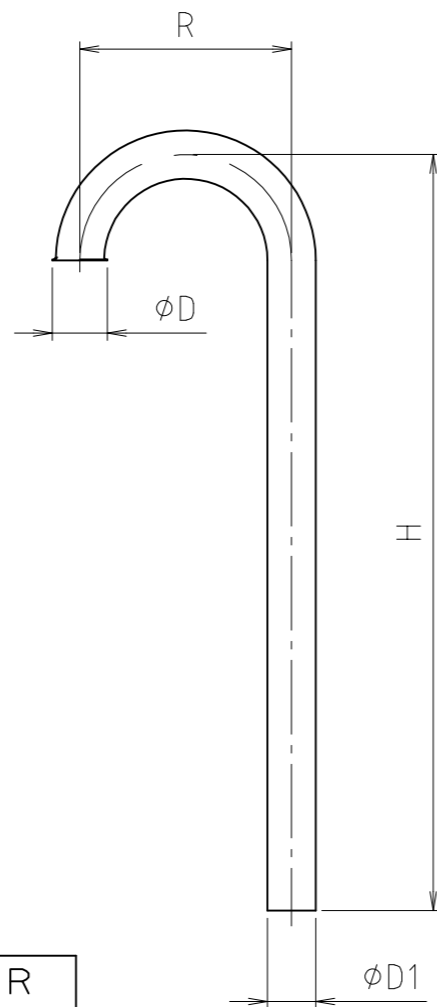

32x500x210
32x500x250

| 寸法 | φD | φD1 | H | R |
|------------|------|-------|-----|-----|
| 25x550x100 | 29.3 | 25.0 | 550 | 100 |
| 25x550x140 | 29.3 | 25.0 | 550 | 140 |
| 25x550x200 | 29.3 | 25.0 | 550 | 200 |
| 32x500x110 | 37.2 | 31.75 | 500 | 110 |
| 32x500x140 | 37.2 | 31.75 | 500 | 140 |
| 32x500x180 | 37.2 | 31.75 | 500 | 180 |
| 32x500x200 | 37.2 | 31.75 | 500 | 200 |
| 32x500x210 | 37.2 | 31.75 | 500 | 210 |
| 32x500x250 | 37.2 | 31.75 | 500 | 250 |
| 38x500x140 | 44.0 | 38.0 | 500 | 140 |
| 38x500x180 | 44.0 | 38.0 | 500 | 180 |

| 1 | 本体 | 黄銅管 | C2700T | |
|----------------|-----------|-----|--------|----------|
| 番号 | 部品名 | 材質名 | 材質記号 | 備考 |
| 品名 | ステッキ (長R) | | | 尺度 |
| 品番 | M6S | | | 原図 A3 |
| 大阪市北区天満1丁目6-7 | | | | フォルダ |
| ミヤコ株式会社 | | | | 1 |
| | | | | 図番 |
| | | | | M6S長R-08 |